



ELITE ROBOTS



# EC68-08 | 6-axis Collaborative Robot

EC SERIES



8kg  
Payload



820mm  
Radius



$\pm 0.03$ mm  
Repeatability



2.5m/s  
Max TCP Speed

# EC68-08

EC SERIES



## Robotic Arm

<b>Payload</b>	8kg
<b>Radius</b>	820mm
<b>Repeatability</b>	±0.03mm
<b>Axis</b>	6
<b>Joints rotation</b>	J1-J6 ±360°
	J1-J2 150°/s
<b>Joints speed</b>	J3 190°/s
	J4-J6 260°/s
<b>Max TCP Speed</b>	2.5m/s
<b>IP rating</b>	IP54
<b>Temperature range</b>	0-50 °C
<b>Relative humidity</b>	5%-95% (non-condensing)
<b>Typical power usage</b>	250w
<b>Mounting</b>	Any angle
<b>Tool I/O connector</b>	12 pin
<b>Tool I/O ports</b>	2 DI, 2 DO, 1 AI, 1 AO
<b>Tool I/O power supply</b>	24V; 2A
<b>Tool I/O communication</b>	RS485
<b>Footprint</b>	Ø 150mm
<b>Weight</b>	17kg
<b>Material</b>	Aluminum, Steel
<b>Cable length</b>	5.5m
<b>Certifications</b>	CE-EMC, CE-MD

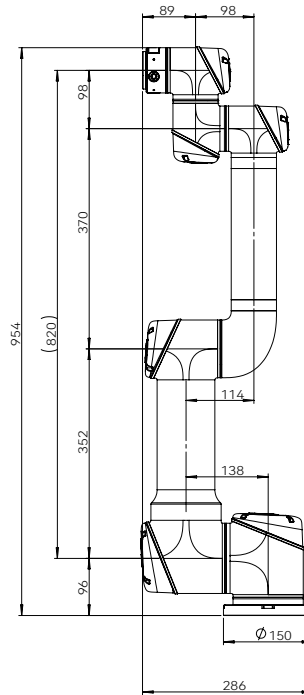

EC68-08 external dimensional drawing

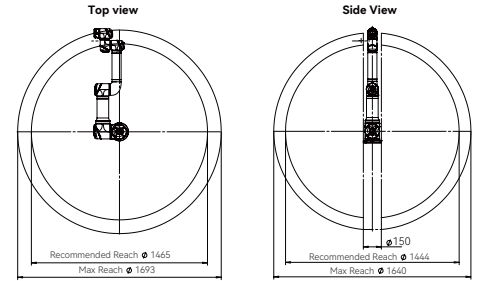

EC68-08 working range diagram

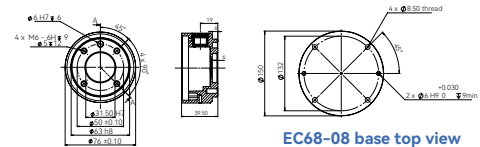

EC68-08 end flange

EC68-08 base top view

## MINI Controller



<b>Size</b>	205mm x 135mm x 44mm
<b>Weight</b>	1.2kg
<b>Material</b>	Aluminum
<b>IP rating</b>	IP40
<b>Power source</b>	45-55VDC
<b>I/O ports</b>	8 DI, 8 DO
<b>I/O power supply</b>	24V; 2A
<b>Communication</b>	Ethernet TCP/IP, UDP, Modbus TCP/RTU, RS485/RS232, Profinet slave, Ethernet IP slave, CCLink slave

## Teach-Pendant



<b>Size</b>	290mm x 225mm x 118mm
<b>Weight</b>	1.2kg
<b>Material</b>	Aluminum, Plastic
<b>IP rating</b>	IP54
<b>Resolution</b>	800 x 600 pixels
<b>Cable length</b>	5.5m
<b>Temperature range</b>	0-50 °C
<b>Input method</b>	Resistive touch-screen, physical keys

## Controller



<b>Size</b>	505mm x 448mm x 245mm
<b>Weight</b>	15kg
<b>Material</b>	Aluminum, Steel
<b>IP rating</b>	IP44
<b>I/O power supply</b>	24V; 2A
<b>I/O ports</b>	16 DI, 20 DO, 2 AI, 4 AO
<b>Temperature range</b>	0-50 °C
<b>Communication</b>	Ethernet TCP/IP, UDP, Modbus TCP/RTU, RS485/RS232, Profinet slave, Ethernet IP slave, CCLink slave